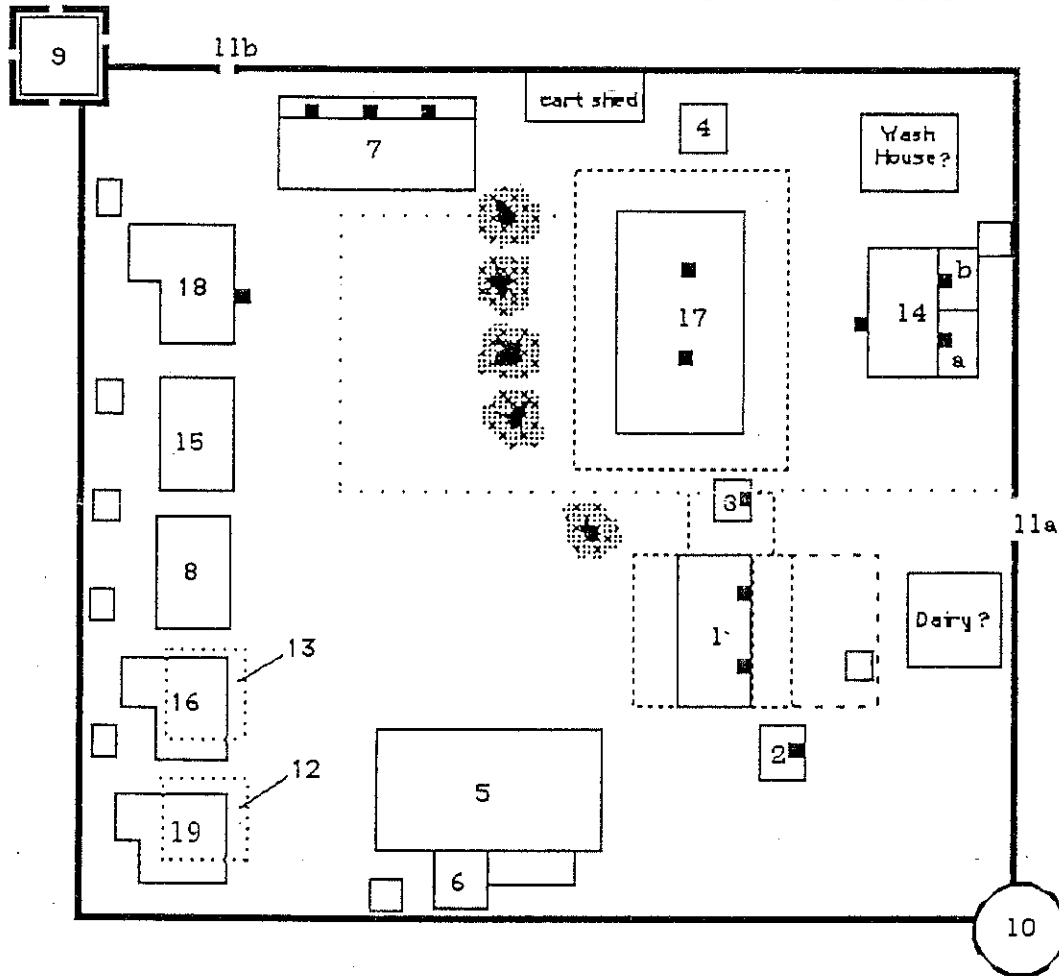

Plate III: Fort Nisqually Developmental Site Plan

Structures That Occurred Between 1843 and 1859



Legend

#	Structure/Feature	Built	Demol'd	Notes:
1.	Tyee/Officer's Dwelling House	1843-44	c. 1895	20 x 30 Cw/ additions.
2.	Old Kitchen	1843-44	1851	Canadian Style.
3.	Clerk's Cabin	1844	1853	Canadian Style, 10' x 15'.
4.	Blockhouse	1844	c. 1850	" Style, photograph avail.
5.	Store No. 1	1844	c. 1890	" Style, Tenalquot style.
6.	Press Shed	1844	1849	60' x 30' " Style, w/additions.
7.	Packing/Press House	1849	1849	Ltd. Information.
8.	Mens' Dwelling House	1845-46	c. 1900	Canadian Style.
9.	Store No. 2	1846	1885	50' x 20' " Style w/additions.
10.	Northwest Bastion	1848	1885	30' x 20' " Style w/additions.
11.	Southeast Bastion	1848	1871	14x14' square, " Style.
11a.	Stockade	1848	1858	14x14'sq.sides? " Style.
11b.	Main Gate: East	1848	1858	20' high. Row of girth rings.
12.	Water Gate: North	1848	1858	10' high. Wagons/horses.
13.	Potatoe House	1848	1858	Man sized.
14.	Potatoe House	c. 1845	1853	Limited Information
15.	Kanaka Dwelling House	"	"	Canadian Style
16.	New Kitchen	1851	1865	Canadian Style
17.	a. Blacksmith Shop	"	"	"
18.	b. Bakery	"	"	"
19.	New Granary	1851	c. 1896	30x20' " Style. Restored.
20.	New Office/Clerk's Dwelling House	1853	c. 1925	20x30' Yankee Style
21.	Factor/Officer's Dwelling House	1854-5	c. 1933	50x30' " w/veranda.
22.	Sales Shop/ Store No. 3	c. 1848	c. 1895	Limited Information.
23.	Forrest/Ross Dwelling House	c. 1849	unknown	Limited information.
24.	Necessaries--usually behind dwellings	unknown	unknown	Limited Information.

Plate III: Fort Nisqually Developmental Site Plan

Structures That Occurred Between 1843 and 1859

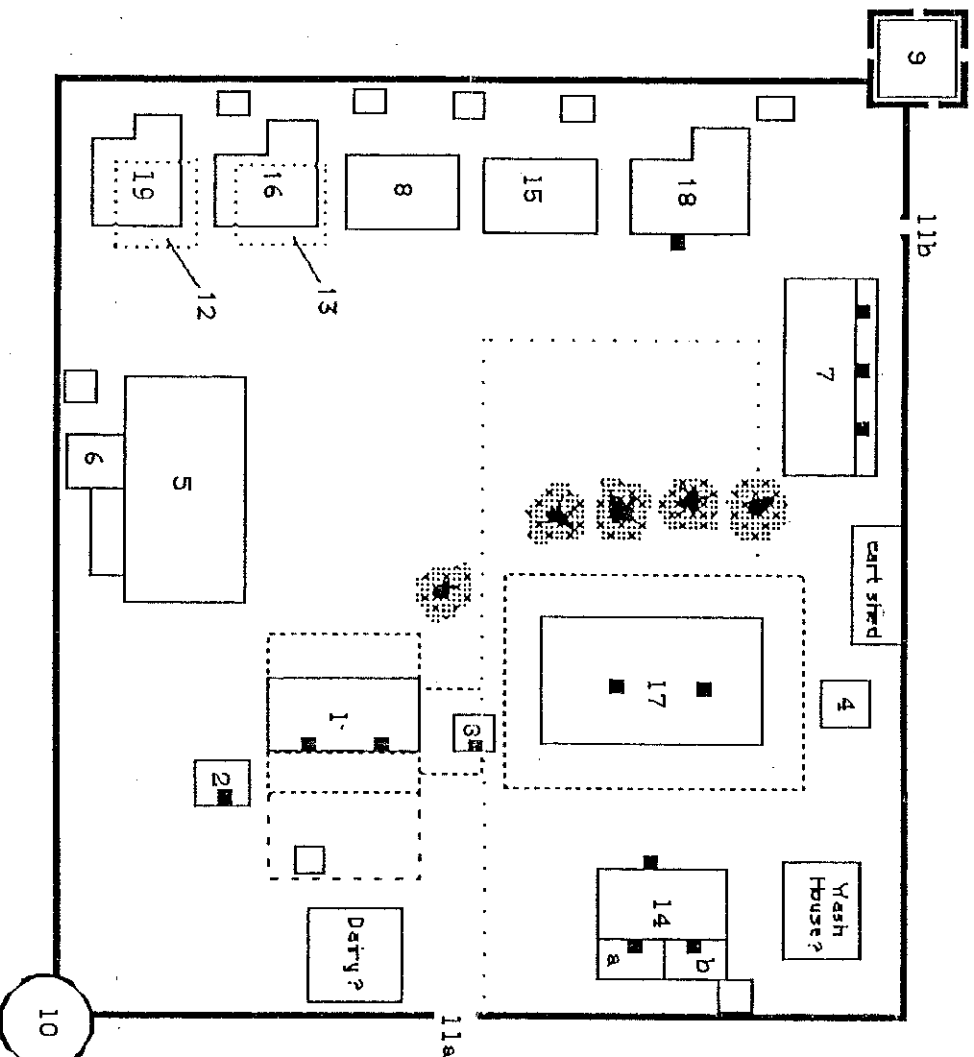

Legend

#	Structure/Feature	Built	Demol'd	Notes:
1.	Tyee/Officer's Dwelling House	1843-44	c. 1895	20 x30 Cw/ additions.
2.	Old Kitchen	1843-44	1851	Canadian Style.
3.	Clerk's Cabin	1844	1853	Canadian Style, 10' x 15'.
4.	1858 Structure	1858	c. 1900	" Style, photograph avail.
5.	Blockhouse	1844	c. 1850	" Style, Tenalquot style.
6.	Store No. 1	1844	c. 1890	60' x 30" Style. w/additions.
7.	Press Shed	1844	1849	Ltd. Information.
8.	Packing/Press House	1849	c. 1900	Canadian Style.
9.	Mens' Dwelling House	1845-46	1865	50' x 20" Style w/additions.
10.	Store No. 2	1846	1885	30' x 20" Style w/additions.
11.	Northwest Bastion	1848	1885	14x14' square. " Style.
11a.	Southeast Bastion	1848	1871	14x14 sq. sides? " Style.
11b.	Stockade	1848	1853	20' high. Row of girth rings.
12.	Main Gate: East	1848	1858	10' high. Wagons/horses.
13.	Water Gate: North	1848	1856	Man sized.
14.	Potatoe House	1848	1853	Limited Information
15.	Kanaka Dwelling House	"	"	Canadian Style
16.	New Kitchen	1851	1865	"
17.	a. Blacksmith Shop	"	"	"
18.	b. Bakery	"	"	"
19.	New Granary	1851	c. 1896	30x20' " Style. Restored.
00.	New Office/Clerk's Dwelling House	1853	c. 1925	20x30' Yankee Style
	Factor/Officer's Dwelling House	1854-5	c. 1933	50x30' " w/Yeranda
	Sales Shop/ Store No. 3	c. 1848	c. 1895	Limited Information.
	Forrest/Ross Dwelling House	c. 1849	unknown	Limited information.
	Necessaries--usually behind dwellings	unknown	unknown	Limited Information.

Fort Nisqually

Hudson's Bay Company and Puget Sound Agriculture Company: Short and long term Employees of Fort Nisqually and surrounding farms from 1833-1859+

Complement of personnel at Fort Nisqually during one outfit.

1 officer (Chief Trader or Chief Factor)

1 clerk

7-17 other personnel

Code (Ku) = Kull Kullee Farm
(Mu) = Muck Farm
(Ou) = Outstation
(Pu) = Puyallup Farm
(Sa) = Sastuc Farm
(Sp) = Spaheuh Farm
(St) = Steilacoom Farm
(Te) = Tenalquot
(Tl) = Tlithlow Farm
(Wh) = Whyatchie Farm
(Ye) = Yelm Farm

<u>Name</u>	<u>Parish</u>	<u>Occupation</u>	<u>Years at Fort Nis.</u>
Allard, Joseph		laborer	1856
Allard, Ovid		laborer	1846-47
Anderson, Alexander C.		clerk	1840-41
		Chief Trader	1846
Andre		laborer	1846
Arioaha	Hawaiian	shepherd (Ou)	1854-59
		laborer	1861-62
Atkinson, William		clerk	1855-56
Aucock, John		supt. of farm operations	1840-41
Audey, Peter		laborer	1855-56
Audey, William		laborer	1855-56
Badayac (Laplante)		farm laborer	1839-40
Barnes, Barnes		laborer, gardener	1851-52
Barr, George		shep., laborer (Tl)	1855
		shep., lab. (Tl) (Sa)	1856
		shepherd (Ou)	1857-59
Bastien, Isaac		midd., laborer	1841-49
		laborer	1856
Bastien, Louis		laborer	1856-57
Bates, Thomas		shep., laborer (Tl)	1856
		farm manager (Tl)	1857
Bayfield, Charles		cooper, laborer	1844-46
Beauvais, Pierre		middleman	1841-43
Beinston, Adam		laborer, Cook	1844-52
		farm manager (Sa)	1851-53

Beinston, William		laborer	1852
Borabora, George		laborer	1850-51
Bottineau, Basil		woodcutter for <i>Beaver</i>	1841
Boulanger, Charles		laborer	1846
Bourdon, Jean Baptiste		laborer	1839
Bourgeau, Silvan		middleman	1834-35
Brown, William		laborer	1834-35
Bull, John		middleman	1838-44
Butler, Peter		laborer	1856
Carless, Joseph		engineer for <i>Beaver</i>	1841
Carre, Jean Baptiste		laborer	1840
Charbonneau, Joseph		middleman	1843-44
Chartier, Antoine		woodcutter for <i>Beaver</i>	1841
Chalifoux, Jean Baptiste		carp., mechanic	1850-59
Cheesman, William		laborer	1853-55
Child, Thomas		laborer	1856
Chinook		laborer	1839-40
Class, James		lab., overseer	1858-59
Collette, Octave		laborer (Ou)	1845-48
Cooper, Thomas		laborer	1849-50
		lab, shep, man. (Sa, Tl)	1853-55
		manager, lab. (Sa)	1856-57
Cournoyer, Edouard		middleman	1841-42
Cowie	Hawaiian	shep., laborer (Mu)	1842-63
Cross, William		laborer (Tl)	1851-55
Cush		laborer, cook	1849-51
		laborer	1855-58
Daines, Henry		Company settler	1846-47
Daly, Robert		carpenter, laborer	1854-55
Daniels, George		lab., herds., shep. (Mu)	1857-59
Dean, Thomas Aubrey		laborer (Tl)	1852-53
Dean, George		laborer	1851-52
Dean, Thomas		farm manager (Tl)	1851-56
Delonie, Louis Henry		boute	1835-36
Edgar, John		farm manager (St)	1845-48
Edwards, George		gardener, laborer	1850-52
Ehoo	Hawaiian	shep., laborer (Ou)	1843-47
Fannons (Farrons), Dominique		laborer	1835-37
Fannons, Dominique, Jr. (?)		laborer's asst.	1857-58
Finlayson, Roderick, Jr.		laborer	1854-56
Flett, John		laborer (Ou)	1847-48
Forrest, Charles		clerk	1849-50
Gale, John		shepherd (Mu)	1858
Gohome		laborer	1858-59
Gorridge, Alfred		laborer?	1853-55
Goudie, James		laborer, blacksmith	1852
Gravelle, Narcisse		laborer	1856
Grieg, William		laborer (Mu)	1854-56
		farm manager (Tl)	1856-59
Gullion, Charles		laborer	1853

Gwakany		laborer	1855-56
Harber, George		gardener, laborer (Tl)	1853-55
Hayward, George		laborer	1851-52
Honnu	Hawaiian	laborer	1839-41
Hoare, Edward		laborer	1850
Hoolio	Hawaiian	middleman	1843-44
Hudson, William		laborer	1851-52
Huggins, Edward		clerk, shopman	1850-55
		farm man.	1856-69
Johnson , Alexis	Canadian	laborer	1852
Johnson, Charles	U.S. Citizen	laborer	1846
Jolibois, Baptiste		shepherd	1849-52
		carp., mechanic	1850
Kahannui	Hawaiian	shep., laborer	1846-60
Kahili Hawaiian		shepherd (Ou)	1849
Kalama	Hawaiian	middleman	1841-42
		shep., laborer	1849-50
		shep., laborer (Tl)	1852-54
		shepherd (Mu)	1856-59
Kalikeeney	Hawaiian	shepherd (Ou)	1859
Kaneoukai	Hawaiian	middleman	1842-43
Keave'haccow	Hawaiian	shep., laborer	1846-48
		laborer	1849-50
		laborer	1851-59
Kelocha	Hawaiian	shepherd (Ou)	1859
Kennedy, Frederick W.		clerk	1853-58
Kingdom, John		blacksmith	1859
Kittson, William		clerk	1834-40
Koemi	Hawaiian	shep., laborer (Ou)	1847-59
Kupahi	Hawaiian	shep., laborer (Ou)	1847-53
		shep., laborer (Ou)	1856
		shep., laborer (Ou)	1858-59
		shep., laborer (Ou)	1859
Lafleur, Jean Baptiste		laborer	1840-41
Lagace, Charles		laborer (Mu, Ou)	1853-58
Lagace, Pierre Sr.		laborer	1853-54
		laborer	1856-58
Lagace, Peter Jr.		laborer	1855-58
Laowala	Hawaiian	shepherd (Ou)	1848
Lapoitre, Jean Baptiste		laborer	1849-52
Larson, Peter?	Scotland	head shepherd?	1841?
Latour (Ballard), Louis		laborer, carpenter	1838-39
		laborer	1840-47
		laborer (Mu)	1856
Leclair, Louis		laborer, Gardener	1850
Ledoux, Louis (Daunt)		laborer	1844-49
Legg, William		laborer (Ou)	1852-58
Lepain, Abraham		middleman	1837-39
L'Hussier (Lucien), Antoine		laborer	1846
Linklater, John		farm manager (Te)	1854-55
Linklater, Thomas		carpenter, interpreter	1846-49
		farm manager (Te), interp.	1849-55

Logan, Kenneth		assistant to clerk	1843
Lord, Richard		laborer	1858
Louttit, William		laborer	1841-44
Low, Jacob		cattleman, lab., butcher	1846-49
McRae, John		laborer	1846
McDonald, Anawiscum		middleman	1834-40
		cooper, carp. & mechanic	1843-46
McDonald, Angus [a]		appr. clerk	1841-42
		clerk, postmaster	1842-43
McDonald, Angus [e]		laborer	1845-46
McDonald, Archibald		Chief Trader	1833
McDonald, Murdoch [b]		laborer	1843-47
		laborer, dairyman	1847-49
McFaddin, James		laborer	1856
McKay, Philip		laborer	1838-39
McKay, John [b]		laborer	1834-35
McLean, Charles		head shepherd	1840-44
McLeod, Ewan (Huey)		laborer, wagonman	1855-59
McLeod, John [d]		laborer	1843-46
		farm mgr (Wh)	1846-49
		farm mgr (Mu)	1851-52
		shepherd (TI)	1855
McLeod, Murdoch [c]		laborer	1843-46
		laborer	1856-59
McNeill, Alfred		laborer (TI)	1857
McPhail, John		farm mgr (TI)	1850-57
Mathe		laborer	1839-40
Millar, James [c]		middleman	1841-42
Moar, John Spenser Logan	Orkney	laborer	1853-55
Montgomery, John E. [a]		farm mgr (Sp)	1841-49
		farm mgr (Sp)	1850-55
		shepherd (TI)	1850, 1856
Mour, Henry		laborer	1835-38
Mowat, Henry		shepherd (Ou)	1847-49
Nahoua	Oahu	shep, horse handler	1842-51
Napahay (Alick)	Oahu	laborer	1858-59
Niaupalu	Oahu	laborer	1848-50
Nelson, Matthew		cook, laborer (Te)	1844-46
		lab., assis. in stores	1846-47
		cook, shep. (Wh)	1847-49
		laborer (Te)	1849
Northover, William		laborer	1851-52
		farm manager (Sa)	1852-53
Nouhee		seaman	1843-44
Ohia		shepherd (Ou)	1846
Oniaze, Baptiste		laborer	1856
Ouvre, Jean Baptiste		interpreter, cook	1834-42
Palmer, George	West Indian Black	cook	1854
Paquet, Jean Baptiste [a]		laborer (Ou)	1846
Perry, Henry	U.S. Citizen	shepherd	1855-56
Pin, Joseph		laborer	1838-41
Plomondon, Simon		middleman	1834-35

Poopoo		middleman	1841-43
Presse, Francois		laborer	1846-47
Puili	Oahu	laborer	1846
Quesnel, Amable		middleman	1835-38
Rabjohn, Fred		shepherd (Mu)	1856
Rivard (Huard), Jean		laborer	1839-41
Robertson, Samuel		laborer	1850
Rocher, Joseph		middleman	1837-38
Ross, Charles Jr.		laborer (Ou)	1849-53
		laborer	1854-56
		laborer (Mu) (Ku)	1856-59
Ross, George		shepherd (Sa)	1857
Ross, John		shepherd (Ou)	1846-49
Ross, Walter Phipps		post master	1846-49
		farm mgr (Ti)	1849-55
Roy, Thomas		boute	1843-44
Sagohaneuchta, Louis		boute	1835-37
St. Martin, Andre		laborer	1841-43
St. Martin, Sauveur		laborer	1838-40
Sales, W.		cook, laborer	1851-52
Sanjoy, Jose		laborer	1854-55
Savard, Joseph		laborer	1845
Scarth, James	at Store blind, into fort	pensioner	1851-56
			1856-58
Shearer, Edward		shep., laborer	1847-49
		head shep. (Ye)	1849
Skinner, Ambrose W.		shep., laborer (Mu)	1856-58
Slocum, Richard		cook, gardener	1841
		lab., cook, gardener	1846-49
Spenser, Edward		clerk, foreman	1858-62
Steel, James		shepherd	1841-42
Taeaanui		middleman	1841-43
Ta-I		laborer	1833-34
Tamaree	Hawaiian	laborer (Ti)	1852-54
Tamaree	Hawaiian	shepherd	1853
Tapou, Joseph	Hawaiian	middleman	1841-43
		shep., laborer (Ou)	1843-45
		shepherd (Te)	1846
		shepherd (Pu)	1847-49
		laborer	1849-50
		shepherd (Ti)	1850-51
		lab., shepherd, FN	1851-55
		shepherd (Ti)	1855-56
		shepherd (Ou)	1858-59
		shepherd	1852-53
Tawaii, William	Hawaiian mix	head shepherd	1841-44
Taylor, Samuel		shep., laborer? (Ou)	1843-44
Tekowe	Hawaiian	housekeeper, cook	1847-49
Thibeault, Joseph		laborer, cook	1851-53
Thornhill, Richard		steward	1854-55
Tod, John		C.T., FN Office	1849-50

Tolmie, William Fraser		clerk & surgeon	1843-47
		Chief Trader	1847-55
		C. F., Agent PSAC	1855-59
Toopanehe		middleman	1840-43
Trudelle, Louis		laborer	1850-51
Turgon, Michel	Metis (invalid)	laborer, carpenter	1846-47
Venn, James		laborer, gardener	1854-55
Vizina, Simon		boute	1841-42
Wahaila	Hawaiian	shepherd (Ou)	1856-57
Walker, Courtney Meade		clerk	1836
Wapping, John		middleman	1841-42
Williams, John [a]		middleman	1836-38
Wilson, Peter		shepherd (Ou)	1847-49
		head shepherd (Ou)	1849
Wooden, M. D.	U.S. Citizen	carpenter	1853-54
Wren, Charles		carp., mechanic	1843-49
Young, William		shepherd (Ou)	1850-53
		laborer, Barr Claim	1854-55
		shepherd (Ou)	1856-59

Sources - Primary

HBCA Servants' Contracts [1820-1925] A.32/18-60 (A-Z); York Factory Abstracts of Servants' Accounts [1833-54] B.239/g/13-33; York Factory District Statements [1833-53] B.239/1/5-23; Fort Vancouver Abstracts of Servants' Accounts [1836-62] B.223/g/3-17; Fort Vancouver Correspondence Books [1833-1853] B.223/b/9-43; Fort Victoria Account Books [1850-1874] B.226/d/1-6; Fort Victoria Abstracts of Servants' Accounts [1853-70] B.226/g/1-17; Fort Victoria District Statements [1852-53] B.226/1/1; Fort Victoria Correspondence Book [1844-66] B.226/b/1-30; Fort Nisqually Correspondence [1850-55] (outward) [1850-55] B.151/b/1-3; Fort Nisqually Correspondence [1842-59] (inward) [1842-62] B.151.c/1; [1857-59] B.226/b/30; Puget Sound Agricultural Company Correspondence Book [1839-56] F.11/1 (outward); Puget Sound Agricultural Company Correspondence Book [1843-53] (inward); Puget Sound Agricultural Company Account Books [1844-74] F.15/8-32; Puget Sound Agricultural Company Miscellaneous Accounts [1840-70] F.15/37-39.

Sources - Primary Printed and Secondary

Fort Nisqually Post Records [1833-87] Huntington Library, San Marino, Calif, as in George Dickie, ed. & trans., *The Journal of Occurrences at Fort Nisqually*, Tacoma, WA: Fort Nisqually Association, 1989, and Steven A. Anderson, *The Physical Structure of Fort Nisqually, A Preliminary Study on the Structure Development of a Hudson's Bay Company Site, 1843-1859*, Tacoma, WA: Metropolitan Park District, 1988; Cecilia Svinth Carpenter, *Fort Nisqually: A Documented History of Indian and British Interaction*, Tacoma, WA: Tahoma Research Publication, 1986

Spread of Employment for Nisqually employees

Administrative Centers

Fort Vancouver
Allard, Joseph [a] (1838-40)

Allard, Ovid (1834-35)
Aucock, John (1839-40)
Badayac (Laplant), Pierre
(1830-37; 1840-41)

Bastien, Isaac (1840-41)
 Bayfield, Charles (1841-44;
 1846-49)
 Beauvais, Pierre (1840-41)
 Borabora, George (1835-36)
 Bourgeau, Silvan (1829-31;
 1832-33; 1835-42)
 Boulanger, Charles (1843-44)
 Brown, William [a] (1831-32)
 Chartier, Antoine (1835-36)
 Collette, Octave (1841-42)
 Cowie (1841-42)
 Daines, Henry (1848-49)
 Delonie, Louis Henry (1841)
 Edgar, John (1841-43)
 Fannons, Dominique (1826-27;
 1837-40)
 Forrest, Charles (1838-40;
 1847-50)
 Honnu (1837-39)
 Jolibois, Jean Baptiste (1830-31)
 Kahannui (1844-46)
 Kalama (1843-47)
 Kaneoukay (1840-42)
 Keave-haccow (1844-45;
 1850-51)
 William Kittson (1840-41)
 Lafleur, Jean Baptiste (1839-40)
 Lagace, Pierre Sr. (1833-36)
 Lapoitre, Jean Baptiste (1838-39)
 Latour (Ballard) Louis (1833-34)
 Leclair, Louis (1839-40)
 Ledoux (Daunt), Louis (1839-40)
 Lepain, Abraham (1833-34; 1836-37)
 L'Hussier, Antoine (1841-42;
 1846-48)
 Linklater, Thomas (1834-36)
 Logan, Kenneth (1841-43;
 1843-49)

 McDonald, Anawiscum (1826-27)
 McDonald, Angus [a] (1839-40;
 1843-48)
 McDonald, Angus [e] (1842-43)
 McDonald, Murdoch (1842-43)
 McKay, John [b] (1832-33)
 McKay, Philip (1833-36; 1837-38;
 1839-45)
 McLeod, John (1841-42)
 McLeod, Murdoch (1842-43;
 1846-48; 1852-56)
 McPhail, John (1833-49)

McRae, John (1842-44)
 Millar, James [c] (1839-40;
 1842-43)
 Mowatt, Henry (1834-35)
 Napahay, Alick (1839-40;
 1851-52)
 Niaupalu (50-51)
 Nouhee (1841-42; 1845-59)
 Ohia (1841-43)
 Oniaze, Baptiste (1846-50)
 Ouvre, Jean Baptiste (1825-43;
 1842-43)
 Plomondon, Simon (1830-31;
 1835-36)
 Poopoo (1840-41; 1843)
 Puili (1844-46)
 Quesnel, Amable (1830-35;
 1838-40)
 Rivard (Huard), Jean (1838-39)
 Rocher, Joseph (1834-37; 1838-39)
 Roy, Thomas (1842-43)
 Sagohaneuchta, Louis (1831-32)
 Savard, Joseph (41-42)
 Scarth, James (1841-58)
 Slocum, Richard (1831-33;
 1835-37)
 Spenser, Edward (1839-50)
 Steel, James (1839-40)
 Taeenui (1840-41; 1843-45)
 Tapow, Joseph (1840)
 Thibeault, Joseph (1841-47;
 1849-51)
 Tod, John (1838-39)
 Tolmie, William F. (1836-41)
 Toopanehe (1846-47)
 Trudelle, Louis (1839-40)
 Tourgeon, Michel (1831-33;
 1836-37; 1843-44)
 Vizina, Simon (1838-41)
 Walker, Courtney Meade (1836-37)
 Wapping, John (1845-48)
 Williams, John [a] (1831-32)

Fort Victoria

Allard, Joseph [a] (1843-47)
 Borabora, George (1854-55)
 Boulanger, Charles (1848-49)
 Bourgeau, Silvan (1831-32)
 Cheeseman, William (1855-59)
 Charbonneau, Joseph (1844-48;
 1850-52)
 Dean, Thomas Aubrey (1851-52)

Gullion, Charles (1850-52;
1853-57)
Lagace, Pierre Sr. (1854-56)
Low, Jacob (1851-52)
McDonald, Angus [e] (1843-45)
McLeod, Ewan (1853-54)
McLeod, John (1843-45)
Nahoua (1852-58)
Pressé, Francois (1839-40;
1846-47)
Robertson, Samuel (1850)
Ross, John (1843-46)
Ross, Walter Phipps (1853)
Sales, William (1851)
Thornhill, Richard (1853-54)
Tolmie, William F. (1860-70)
Trudelle, Louis (1848-50;
1851-52)
Venn, John (1850-52)

Other Posts

Fort Alexandria

Anderson, A. C. (1842-48)
McFaddin, James (1850-51)
McLeod, Ewan (1850-51)
Plomondon, Simon (1824-25)
Tod, John (1840; 1842)

Fort Babine

Delonie, Louis Henry (1822-23)
Logan, Kenneth (1850-51)

Fort Colville

Anderson, A. C. (1848-53)
Goudie, James (1830-51)
Kittson, William (1825-34)
McDonald, Angus [a] (1838-39)
McDonald, Archibald (1835-44)
Pin, Joseph (1826-38)
Plomondon, Simon (1827-28)
Roy, Thomas (1846-49)

Fort Fraser/Fraser Lake

Anderson, A. C. (1836-39)

Fort George/New Caledonia

Anderson, A. C. (1835-36)
Tod, John (1823-24)

Fort George/Astoria

Forrest, Charles (1846-47)

McDonald, Archibald (1821-26)
McKay, Philip (1836-37)
Ouvre, Jean Baptiste (1813-25)
Quesnel, Amable (1822)
Spenser, Edward (1849-50)

Fort Langley

Allard, Ovid (1839-53;
1858-74)
Atkinson, William (1851-53)
Borabora, George (1841-50;
1850-52)
Bourgeau, Silvan ((1833-34)
Brown, William [a] (1832-33;
1833-35)
Delonie, Louis Henry (1828-35;
1836-41)
Fannons, Dominique (1827-35)
Keave-haccow (1848-49)
Laowala (1839-48)
Logan, Kenneth (1851-52)
McDonald, Anawiscum (1827-34)
McDonald, Archibald (1828-33)
McFaddin, James (1852-53)
McKay, John [b] (1833-34)
Ohia (1846-56)
Ouvre, Jean Baptiste (1833-34)
Plomondon, Simon (1828-30)
Sagohaneuchta, Louis (1832-34)
Ta-I (1834-48; 1830-33)
Williams, John [a] (1835-36)
McDonald, Archibald (1828-33)

Fort McLoughlin

Anderson, A. C. (1832-33)
Borabora, George (1836-41)
Bottineau, Basil (1840-41)
Chartier, Antoine (1836-41)
Linklater, Thomas (1836-43)
Tolmie, William F. (1834-36)

Fort Nez Percés/Walla Walla

Kalama (1837-40)
Kittson, William (1819)
Pin, Joseph (1822)
Tourgeon, Michel (1834-36)
Wapping, John (1842-43)

Fort Rupert

Legg, William L. (1850-51)
Nahoua (1854)
Tawaii, William (1854-60)

Fort St. James

Delonie, Louis Henry (1824-25)
Jollibois, Jean Baptiste (1824-25)
Plomondon, Simon (1824)

Fort Simpson

Anderson, A. C. (1833-35)
Bottineau, Basil (1839-40)
Boulangier, Charles (1838-39)
Bourgeau, Silvan (1831-32)
Gullion, Charles (1867-68)
Jollibois, Jean Baptiste (1831-49)
Lagace, Pierre Sr. (1836-53)
Latour (Ballard), Louis (1834-38)
Lepain, Abraham (1834-36)
McDonald, Angus [a] (1840-41)
McLeod, John [d] (1838-40)
Paquet, Jean Baptiste (1846-51;
1853-60)
Plomondon, Simon (1831-34)
Slocum, Richard (1834-35)
Tolmie, William F. (1833-34)
Tourgeon, Michel (33-34)
Williams, John [a] (1832-35)

Fort Stikine

Bottineau, Basil (1844-49)
Boulangier, Charles (1840-42;
1845-48)
Chalifoux, J. B. (1842-46)
Colletee, Octave (1843-44)
Cournoyer, Edouard (1842-44)
Leclair, Louis (1840-42)
L'Hussier, Antoine (1843-46)
Nahoua (1840-47)
Pressé, Francois (1840-42)
Puili (1844-46)
Savard, Joseph (1844-45)
Trudelle, Louis (1843-48)
Vizina, Simon (1842-43)

Fort Taku

Allard, Joseph [a] (1840-42)
Trudelle, Louis (1840-43)

McLeod Lake

Tod, John (1824-32)

New Caledonia

Anderson, A. C. (1835-36)
Delonie, Louis Henry (1823-24)

Fannons, Dominique (1825-26)
Finlayson, Roderick, Jr. (1857-58)
Jollibois, Jean Baptiste (1825-30)
Latour (Ballard), Louis (1839-40)
Plomondon, Simon (1823-24;
1825-27)
Vizina, Simon (1833-37)

Snake Country

Kalama (1840-41)
Keave-haccow (1845-46)
Pin, Joseph (1824-25)
Quesnel, Amable (1826-30)
Taenui (1841)
Walker, Courtney Meade (1837-40)
Williams, John [a] (1839)

Thompson River

McDonald, Archibald (1826-28)
McLeod, Ewan (1850-51)
Tod, John (1841-49)

Willamette Falls

McDonald, Murdoch (1848-49)

Farms

Belle Vue Sheep Farm

Bull, John (1849-60)
Low, Jacob (1854-59)
McLeod, Ewan (1854)
Nahoua (1854)

Colwood Farm

Cooper, Thomas (1855-56)

Cowlitz Farm

Badayac (Laplant), Pierre (1838-40)
Bull, John (1844-46)
Chalifoux, Jean Baptiste (1846)
Ehoo (1841-43)
Forrest, Charles (1841-46)
Hoolio (1841-43; 1844-47)
Huggins, Edward (1852-53)
Johnson, John (1840-42)
Kalama (1847-49)
Lapoitre, Jean Baptiste (1839-49)
Leclair, Louis (1841-50)
Ledoux (Daunt), Louis (1840-44;
1849-52)
Legg, William L. (1851-52)
Mowatt, Henry (1840-41)

Rocher, Joseph (1839-41)
St. Martin, Andre (1838-41)
Tekowe (1841-43; 1844-46)
Tod, John (1838-39)

Viewfield Farm

McLeod, Ewan (1852-53)

Ships

steamer *Beaver*

Bottineau, Basil (1841-44)
Boulangier, Charles (1839-40)
Carless, Joseph (1840-46)
Charbonneau, Joseph (1848-50;
1853-54)
Chartier, Antoine (1841-53)
Cooper, Thomas (1841; 1842-49)
Harber, George (1851-53)
Lafleur, Jean Baptiste (1841-42)
L'Hussier, Antoine (1842-43)
Linklater, Thomas (1843-46)
McRae, John (1844-46)

McLeod, John (1839-41;
1842-43)
Mowatt, Henry (1838-40)
Ohia (1843-45)
Paquet, Jean Baptiste (1851-53)
Rivard (Huard), Jean (1841-42)
Roy, Thomas (1844-45)
Savard, Joseph (1842-44)
Slocum, Richard (1837-46)
Toopanehe (1843-45)
Tourgeon, Michel (1837-42;
1844-46)
Vizina, Simon (1837-38)

schooner *Cadboro*

Napahay, Alick (1840-42)
Ohia (1843)
Slocum, Richard (1833)

Bruce M. Watson
October 2008

Fort Nisqually

Hudson's Bay Company and Puget Sound Agriculture Company: Short and long term Employees of Fort Nisqually and surrounding farms from 1833-1859+

Complement of personnel at Fort Nisqually during one outfit

1 officer (Chief Trader or Chief Factor)

1 clerk

7-17 other personnel

<u>Code</u>	<u>(Ku) = Kull Kullee Farm</u>	<u>(Mu) = Muck Farm</u>	<u>(Ou) = Outstation</u>	<u>(Pu) = Puyallup Farm</u>	<u>(Sa) = Sastic Farm</u>	<u>(Sp) = Spahewh Farm</u>	<u>(St) = Steilacoom Farm</u>	<u>(Te) = Tenalquot</u>	<u>(Tl) = Tlithlow Farm</u>	<u>(Wh) = Whyatchie Farm</u>	<u>(Ye) = Yelm Farm</u>
<u>Name</u>	<u>Parish</u>	<u>Occupation</u>	<u>Years at Fort Nis.</u>								
Allard, Joseph		laborer	1856								
Allard, Ovid		laborer	1846-47								
Anderson, Alexander C.		clerk	1840-41								
		Chief Trader	1846								
Andre		laborer	1846								
Arioha	Hawaiian	shepherd (Ou)	1854-59								
		laborer	1861-62								
		clerk	1855-56								
Atkinson, William		supt. of farm operations	1840-41								
Aucock, John		laborer	1855-56								
Audey, Peter		laborer	1855-56								
Audey, William		farm laborer	1839-40								
Badayac (Laplante)		laborer, gardener	1851-52								
Barnes, Barnes		shep., laborer (Tl)	1855								
Barr, George		shep., lab. (Tl) (Sa)	1856								
		shepherd (Ou)	1857-59								
		midd., laborer	1841-49								
Bastien, Isaac		laborer	1856								
		laborer	1856-57								
Bastien, Louis		shep., laborer (Tl)	1856								
Bates, Thomas		farm manager (Tl)	1857								
		cooper, laborer	1844-46								
Bayfield, Charles		middleman	1841-43								
Beauvais, Pierre		laborer, Cook	1844-52								
Beinston, Adam		farm manager (Sa)	1851-53								

Beinston, William	laborer	1852
Borabora, George	laborer	1850-51
Bottineau, Basil	woodcutter for <i>Beaver</i>	1841
Boulanger, Charles	laborer	1846
Bourdon, Jean Baptiste	laborer	1839
Bourgeau, Silvan	middleman	1834-35
Brown, William	laborer	1834-35
Bull, John	middleman	1838-44
Butler, Peter	laborer	1856
Carlless, Joseph	engineer for <i>Beaver</i>	1841
Carre, Jean Baptiste	laborer	1840
Charbonneau, Joseph	middleman	1843-44
Chartier, Antoine	woodcutter for <i>Beaver</i>	1841
Chalifoux, Jean Baptiste	carp, mechanic	1850-59
Cheesman, William	laborer	1853-55
Child, Thomas	laborer	1856
Chinook	laborer	1839-40
Class, James	lab, overseer	1858-59
Collette, Octave	laborer (Ou)	1845-48
Cooper, Thomas	laborer	1849-50
	lab, shep, man. (Sa, Tl)	1853-55
	manager, lab. (Sa)	1856-57
	middleman	1841-42
Cournoyer, Edouard	shep, laborer (Mu)	1842-63
Cowie	laborer (Tl)	1851-55
Cross, William	laborer, cook	1849-51
Cush		
	laborer	1855-58
Daines, Henry	Company settler	1846-47
Daly, Robert	carpenter, laborer	1854-55
Daniels, George	lab, herds., shep. (Mu)	1857-59
Dean, Thomas Aubrey	laborer (Tl)	1852-53
Dean, George	laborer	1851-52
Dean, Thomas	farm manager (Tl)	1851-56
Delonie, Louis Henry	boute	1835-36
Edgar, John	farm manager (St)	1845-48
Edwards, George	gardener, laborer	1850-52
Ehoo	shep., laborer (Ou)	1843-47
Farrons (Farrons), Dominique	laborer	1835-37
	laborer's asst	1857-58
Farrons, Dominique, Jr. (?)	laborer	1854-56
Finlayson, Roderick, Jr.	laborer (Ou)	1847-48
Flett, John	clerk	1849-50
Forrest, Charles	shepherd (Mu)	1858
Gale, John	laborer	1858-59
Gohome	laborer?	1853-55
Gorridge, Alfred	laborer, blacksmith	1852
Goudie, James	laborer	1856
Gravelle, Narcisse	laborer (Mu)	1854-56
Grieg, William	farm manager (Tl)	1856-59
Gullion, Charles	laborer	1853

Gwakany		laborer	1855-56
Harber, George		gardener, laborer (Ti)	1853-55
Hayward, George		laborer	1851-52
Honnu	Hawaiian	laborer	1839-41
Hoare, Edward		laborer	1850
Hoolio	Hawaiian	middlemann	1843-44
Hudson, William		laborer	1851-52
Huggins, Edward		clerk, shopman	1850-55
		farm man.	1856-69
Johnson, Alexis	Canadian	laborer	1852
Johnson, Charles	U.S. Citizen	laborer	1846
Jolibois, Baptiste		shepherd	1849-52
		carp., mechanic	1850
Kahannui	Hawaiian	shep., laborer	1846-60
Kahili Hawaiian		shepherd (Ou)	1849
Kalama	Hawaiian	middlemann	1841-42
		shep., laborer	1849-50
Kalikeaney	Hawaiian	shep., laborer (Ti)	1852-54
Kaneoukai	Hawaiian	shepherd (Mu)	1856-59
Keavehacow	Hawaiian	shepherd (Ou)	1859
		middlemann	1842-43
		shep., laborer	1846-48
		laborer	1849-50
		laborer	1851-59
Kelocha	Hawaiian	shepherd (Ou)	1859
Kennedy, Frederick W.		clerk	1853-58
Kingdom, John		blacksmith	1859
Kittson, William		clerk	1834-40
Koemi	Hawaiian	shep., laborer (Ou)	1847-59
Kupahi	Hawaiian	shep., laborer (Ou)	1847-53
		shep., laborer (Ou)	1856
		shep., laborer (Ou)	1858-59
		shep., laborer (Ou)	1859
		laborer	1840-41
Lafleur, Jean Baptiste		laborer (Mu, Ou)	1853-58
Lagace, Charles		laborer	1853-54
Lagace, Pierre Sr.		laborer	1856-58
		laborer	1855-58
Lagace, Peter Jr.		laborer	1848
Laowala	Hawaiian	shepherd (Ou)	1849-52
Lapoitre, Jean Baptiste		laborer	1841?
Larson, Peter?	Scotland	head shepherd?	1838-39
Latour (Ballard), Louis		laborer, carpenter	1840-47
		laborer	1856
		laborer (Mu)	1850
Leclaire, Louis		laborer, Gardener	1844-49
Ledoux, Louis (Daunt)		laborer	1852-58
Legg, William		laborer (Ou)	1837-39
Lepain, Abraham		middlemann	1846
L'Hussier (Lucien), Antoine		laborer	1854-55
Linklater, John		farm manager (Te)	1846-49
Linklater, Thomas		carpenter, interpreter	1849-55
		farm manager (Te), interp.	

Logan, Kenneth		assistant to clerk	1843
Lord, Richard		laborer	1858
Louittie, William		laborer	1841-44
Low, Jacob		cattleman, lab., butcher	1846-49
McRae, John		laborer	1846
McDonald, Anawiscum		middleman	1834-40
McDonald, Angus [a]		cooper, carp. & mechanic	1843-46
McDonald, Angus [e]		appr. clerk	1841-42
McDonald, Archibald		clerk, postmaster	1842-43
McDonald, Murdoch [b]		laborer	1845-46
		Chief Trader	1833
McFaddin, James		laborer	1843-47
		laborer, dairyman	1847-49
		laborer	1856
McKay, Philip		laborer	1838-39
McKay, John [b]		laborer	1834-35
McLean, Charles		head shepherd	1840-44
McLeod, Ewan (Huey)		laborer, wagonman	1855-59
McLeod, John [d]		laborer	1843-46
		laborer	1846-49
		farm mgr (Wh)	1851-52
		farm mgr (Mu)	1851-52
		shepherd (Tl)	1855
McLeod, Murdoch [c]		laborer	1843-46
		laborer	1856-59
McNeill, Alfred		laborer (Tl)	1857
McPhail, John		farm mgr (Tl)	1850-57
Mathe		laborer	1839-40
Miller, James [c]		middleman	1841-42
Moar, John Spenser Logan	Orkney	laborer	1853-55
Montgomery, John E. [a]		farm mgr (Sp)	1841-49
		farm mgr (Sp)	1850-55
		shepherd (Tl)	1850, 1856
		laborer	1835-38
Mour, Henry		shepherd (Ou)	1847-49
Mowat, Henry	Oahu	shep, horse handler	1842-51
Nahoua	Oahu	laborer	1858-59
Napahay (Alick)		laborer	1848-50
Niapalu	Oahu	cook, laborer (Te)	1844-46
Nelson, Matthew		lab., assis. in stores	1846-47
		cook, shep. (Wh)	1847-49
		laborer (Te)	1849
		laborer	1851-52
		farm manager (Sa)	1852-53
Northover, William		seaman	1843-44
		shepherd (Ou)	1846
Nouhee		laborer	1856
Ohio		interpreter, cook	1834-42
Oniaze, Baptiste		cook	1854
Ouvtre, Jean Baptiste	West Indian Black	laborer (Ou)	1846
Palmer, George		shepherd	1855-56
Paguet, Jean Baptiste [a]	U.S. Citizen	laborer	1838-41
Perry, Henry		middleman	1834-35
Pin, Joseph			
Plomondon, Simon			

Tolmie, William Fraser		clerk & surgeon	1843-47
		Chief Trader	1847-55
Toopanehe		C. F., Agent P5AC	1855-59
Trudelle, Louis		middleman	1840-43
Turgon, Michel	Metis (invalid)	laborer	1850-51
Venn, James		laborer, carpenter	1846-47
Vizina, Simon		laborer, gardener	1854-55
Wahala		route	1841-42
Walker, Courtney Meade	Hawaiian	shepherd (Ou)	1856-57
Wapping, John		clerk	1836
Williams, John [a]		middleman	1841-42
Wilson, Peter		shepherd (Ou)	1836-38
		head shepherd (Ou)	1847-49
Wooden, M. D.	U.S. Citizen	carpenter	1849
Wren, Charles		carp.	1853-54
Young, William		carp., mechanic	1843-49
		shepherd (Ou)	1850-53
		laborer, Barr Claim	1854-55
		shepherd (Ou)	1856-59

Sources - Primary

HBCA Servants' Contracts [1820-1925] A.32/18-60 (A-Z); York Factory Abstracts of Servants' Accounts [1833-54] B.239/g/13-33; York Factory District Statements [1833-53] B.239/1/5-23; Fort Vancouver Abstracts of Servants' Accounts [1836-62] B.223/g/3-17; Fort Vancouver Correspondence Books [1833-1853] B.223/b/9-43; Fort Victoria Account Books [1850-1874] B.226/d/1-6; Fort Victoria Abstracts of Servants' Accounts [1853-70] B.226/g/1-17; Fort Victoria District Statements [1852-53] B.226/1/1; Fort Victoria Correspondence Book [1844-66] B.226/b/1-30; Fort Nisqually Correspondence [1850-55] (outward) [1850-55] B.151/b/1-3; Fort Nisqually Correspondence [1842-59] (inward) [1842-62] B.151.c/1; [1857-59] B.226/b/30; Puget Sound Agricultural Company Correspondence Book [1839-56] F.11/1 (outward); Puget Sound Agricultural Company Correspondence Book [1843-53] (inward); Puget Sound Agricultural Company Account Books [1844-74] F.15/8-32; Puget Sound Agricultural Company Miscellaneous Accounts [1840-70] F.15/37-39.

Sources - Primary Printed and Secondary

Fort Nisqually Post Records [1833-87] Huntington Library, San Marino, Calif, as in George Dickie, ed. & trans., *The Journal of Occurrences at Fort Nisqually*, Tacoma, WA: Fort Nisqually Association, 1989, and Steven A. Anderson, *The Physical Structure of Fort Nisqually, A Preliminary Study on the Structure Development of a Hudson's Bay Company Site, 1843-1859*, Tacoma, WA: Metropolitan Park District, 1988; Cecilia Svrinith Carpenter, *Fort Nisqually: A Documented History of Indian and British Interaction*, Tacoma, WA: Tahoma Research Publication, 1986

Spread of Employment for Nisqually employees

Administrative Centers

Fort Vancouver
Allard, Joseph [a] (1838-40)

Allard, Ovid (1834-35)
Ancock, John (1839-40)
Badayac (Laplant), Pierre
(1830-37; 1840-41)

Bastien, Isaac (1840-41)
 Bayfield, Charles (1841-44;
 1846-49)
 Beauvais, Pierre (1840-41)
 Borabora, George (1835-36)
 Bourgeau, Silvan (1829-31;
 1832-33; 1835-42)
 Boulanger, Charles (1843-44)
 Brown, William [a] (1831-32)
 Chartier, Antoine (1835-36)
 Collette, Octave (1841-42)
 Cowie (1841-42)
 Daines, Henry (1848-49)
 Delonie, Louis Henry (1841)
 Edgar, John (1841-43)
 Fannons, Dominique (1826-27;
 1837-40)
 Forrest, Charles (1838-40;
 1847-50)
 Honnu (1837-39)
 Jolibois, Jean Baptiste (1830-31)
 Kahannui (1844-46)
 Kalama (1843-47)
 Kaneoukay (1840-42)
 Keave-haccow (1844-45;
 1850-51)
 William Kittson (1840-41)
 Lafleur, Jean Baptiste (1839-40)
 Lagace, Pierre Sr. (1833-36)
 Lapoite, Jean Baptiste (1838-39)
 Latour (Ballard) Louis (1833-34)
 Leclaire, Louis (1839-40)
 Ledoux (Daunt), Louis (1839-40)
 Lepain, Abraham (1833-34; 1836-37)
 L'Hussier, Antoine (1841-42;
 1846-48)
 Linklater, Thomas (1834-36)
 Logan, Kenneth (1841-43;
 1843-49)
 McDonald, Anawiscunn (1826-27)
 McDonald, Angus [a] (1839-40;
 1843-48)
 McDonald, Angus [e] (1842-43)
 McDonald, Murdoch (1842-43)
 Mckay, John [b] (1832-33)
 Mckay, Philip (1833-36; 1837-38;
 1839-45)
 McLeod, John (1841-42)
 McLeod, Murdoch (1842-43;
 1846-48; 1852-56)
 McPhail, John (1833-49)

MCRae, John (1842-44)
 Millar, James [c] (1839-40;
 1842-43)
 Mowatt, Henry (1834-35)
 Napahay, Alick (1839-40;
 1851-52)
 Niaupalu (50-51)
 Nouhee (1841-42; 1845-59)
 Ohia (1841-43)
 Oniaze, Baptiste (1846-50)
 Ouvre, Jean Baptiste (1825-43;
 1842-43)
 Plomondon, Simon (1830-31;
 1835-36)
 Poopoo (1840-41; 1843)
 Puli (1844-46)
 Quesnel, Arnable (1830-35;
 1838-40)
 Rivard (Huard), Jean (1838-39)
 Rocher, Joseph (1834-37; 1838-39)
 Roy, Thomas (1842-43)
 Sagohaneucta, Louis (1831-32)
 Savard, Joseph (41-42)
 Scarth, James (1841-58)
 Slocunn, Richard (1831-33;
 1835-37)
 Spenser, Edward (1839-50)
 Steel, James (1839-40)
 Taaenui (1840-41; 1843-45)
 Tapow, Joseph (1840)
 Thibeault, Joseph (1841-47;
 1849-51)
 Tod, John (1838-39)
 Tolmie, William F. (1836-41)
 Toopanehe (1846-47)
 Trudelle, Louis (1839-40)
 Tourgeon, Michel (1831-33;
 1836-37; 1843-44)
 Vizina, Simon (1838-41)
 Walker, Courtney Meade (1836-37)
 Wapping, John (1845-48)
 Williams, John [a] (1831-32)

Fort Victoria
 Allard, Joseph [a] (1843-47)
 Borabora, George (1854-55)
 Boulanger, Charles (1848-49)
 Bourgeau, Silvan (1831-32)
 Cheeseman, William (1855-59)
 Charbonneau, Joseph (1844-48;
 1850-52)
 Dean, Thomas Aubrey (1851-52)

Gullion, Charles (1850-52;
1853-57)
Lagace, Pierre Sr. (1854-56)
Low, Jacob (1851-52)
McDonald, Angus [e] (1843-45)
McLeod, Ewan (1853-54)
McLeod, John (1843-45)
Nahoua (1852-58)
Pressé, Francois (1839-40;
1846-47)
Robertson, Samuel (1850)
Ross, John (1843-46)
Ross, Walter Phipps (1853)
Sales, William (1851)
Thornhill, Richard (1853-54)
Tolmie, William F. (1860-70)
Trudelle, Louis (1848-50;
1851-52)
Venn, John (1850-52)

Other Posts

Fort Alexandria
Anderson, A. C. (1842-48)
McFaddin, James (1850-51)
McLeod, Ewan (1850-51)
Plomondon, Simon (1824-25)
Tod, John (1840; 1842)

Fort Babine
Delonie, Louis Henry (1822-23)
Logan, Kenneth (1850-51)

Fort Colvile
Anderson, A. C. (1848-53)
Goudie, James (1830-51)
Kittson, William (1825-34)
McDonald, Angus [a] (1838-39)
McDonald, Archibald (1835-44)
Pin, Joseph (1826-38)
Plomondon, Simon (1827-28)
Roy, Thomas (1846-49)

Fort Fraser/Fraser Lake
Anderson, A. C. (1836-39)

Fort George/New Caledonia
Anderson, A. C. (1835-36)
Tod, John (1823-24)

Fort George/Astoria
Forrest, Charles (1846-47)

McDonald, Archibald (1821-26)
McKay, Philip (1836-37)
Ouvre, Jean Baptiste (1813-25)
Quesnel, Amable (1822)
Spenser, Edward (1849-50)

Fort Langley
Allard, Ovid (1839-53;
1858-74)
Atkinson, William (1851-53)
Borabora, George (1841-50;
1850-52)
Bourgeau, Silvan (1833-34)
Brown, William [a] (1832-33;
1833-35)
Delonie, Louis Henry (1828-35;
1836-41)
Fannons, Dominique (1827-35)
Keave-haccow (1848-49)
Laowala (1839-48)
Logan, Kenneth (1851-52)
McDonald, Anawiscum (1827-34)
McDonald, Archibald (1828-33)
McFaddin, James (1852-53)
McKay, John [b] (1833-34)
Ohia (1846-56)
Ouvre, Jean Baptiste (1833-34)
Plomondon, Simon (1828-30)
Sagohaneuchta, Louis (1832-34)
Ta-I (1834-48; 1830-33)
Williams, John [a] (1835-36)
McDonald, Archibald (1828-33)

Fort McLoughlin
Anderson, A. C. (1832-33)
Borabora, George (1836-41)
Bottineau, Basil (1840-41)
Chartier, Antoine (1836-41)
Linklater, Thomas (1836-43)
Tolmie, William F. (1834-36)

Fort Nez Perces/Walla Walla
Kalama (1837-40)
Kittson, William (1819)
Pin, Joseph (1822)
Tourgeon, Michel (1834-36)
Wapping, John (1842-43)

Fort Rupert
Legg, William L. (1850-51)
Nahoua (1854)
Tawaiti, William (1854-60)

Fort St. James

Delonnie, Louis Henry (1824-25)
Jolibois, Jean Baptiste (1824-25)
Plomondon, Simon (1824)

Fort Simpson

Anderson, A. C. (1833-35)
Bottineau, Basil (1839-40)
Boulanger, Charles (1838-39)
Bourgeau, Sylvan (1831-32)
Gullion, Charles (1867-68)
Jolibois, Jean Baptiste (1831-49)
Lagace, Pierre Sr. (1836-53)
Latour (Ballard), Louis (1834-38)
Lepain, Abraham (1834-36)
McDonald, Angus [a] (1840-41)
McLeod, John [d] (1838-40)
Paquet, Jean Baptiste (1846-51;
1853-60)
Plomondon, Simon (1831-34)
Siocum, Richard (1834-35)
Tolmie, William F. (1833-34)
Tourgeon, Michel (33-34)
Williams, John [a] (1832-35)

Fort Stikine

Bottineau, Basil (1844-49)
Boulanger, Charles (1840-42;
1845-48)
Chalifoux, J. B. (1842-46)
Colletee, Octave (1843-44)
Cournoyer, Edouard (1842-44)
Leclaire, Louis (1840-42)
L'Hussier, Antoine (1843-46)
Nahoua (1840-47)
Pressé, Francois (1840-42)
Puilh (1844-46)
Savard, Joseph (1844-45)
Trudelle, Louis (1843-48)
Vizina, Simon (1842-43)

Fort Taku

Allard, Joseph [a] (1840-42)
Trudelle, Louis (1840-43)

McLeod Lake

Tod, John (1824-32)

New Caledonia

Anderson, A. C. (1835-36)
Delonnie, Louis Henry (1823-24)

Fannons, Dominique (1825-26)

Finlayson, Roderick, Jr. (1857-58)

Jolibois, Jean Baptiste (1825-30)

Latour (Ballard), Louis (1839-40)

Plomondon, Simon (1823-24;
1825-27)

Vizina, Simon (1833-37)

Snake Country

Kalama (1840-41)
Keave-haccow (1845-46)
Pin, Joseph (1824-25)
Quesnel, Amable (1826-30)
Taeemui (1841)
Walker, Courtney Meade (1837-40)
Williams, John [a] (1839)

Thompson River

McDonald, Archibald (1826-28)
McLeod, Ewan (1850-51)
Tod, John (1841-49)

Willanette Falls

McDonald, Murdoch (1848-49)

Farms

Belle Vue Sheep Farm

Bull, John (1849-60)
Low, Jacob (1854-59)
McLeod, Ewan (1854)
Nahoua (1854)

Colwood Farm

Cooper, Thomas (1855-56)

Cowlitz Farm

Badayac (Laplant), Pierre (1838-40)
Bull, John (1844-46)
Chalifoux, Jean Baptiste (1846)
Ehoo (1841-43)
Forrest, Charles (1841-46)
Hooilo (1841-43; 1844-47)
Huggins, Edward (1852-53)
Johnson, John (1840-42)
Kalama (1847-49)
Lapoitre, Jean Baptiste (1839-49)
Leclaire, Louis (1841-50)
Ledoux (Daunt), Louis (1840-44;
1849-52)
Legg, William L. (1851-52)
Mowatt, Henry (1840-41)

Rocher, Joseph (1839-41)
St. Martin, Andre (1838-41)
Tekowe (1841-43; 1844-46)
Tod, John (1838-39)

Viewfield Farm
McLeod, Ewan (1852-53)

Ships

steamer Buzzer
Bottineau, Basil (1841-44)
Boullanger, Charles (1839-40)
Carlless, Joseph (1840-46)
Charbonneau, Joseph (1848-50;
1853-54)
Chartier, Antoine (1841-53)
Cooper, Thomas (1841, 1842-49)
Harber, George (1851-53)
Lafleur, Jean Baptiste (1841-42)
L'Hussier, Antoine (1842-43)
Linklater, Thomas (1843-46)
McRae, John (1844-46)

McLeod, John (1839-41;
1842-43)
Mowatt, Henry (1838-40)
Ohia (1843-45)
Paquet, Jean Baptiste (1851-53)
Rivard (Huard), Jean (1841-42)
Roy, Thomas (1844-45)
Savard, Joseph (1842-44)
Slocum, Richard (1837-46)
Toopanelhe (1843-45)
Tourgeon, Michel (1837-42;
1844-46)
Vizina, Simon (1837-38)

schooner Cariboro
Napahay, Alick (1840-42)
Ohia (1843)
Slocum, Richard (1833)

Bruce M. Watson
October 2008